

ADAPTA-WALL

Assembly Instructions – Wall Mounted

INSPECT THE UNIT BEFORE INSTALLING

WARNING: Watch for pinch points. Do not put your fingers between movable parts. Do not tamper with the mount assembly.

1. Carefully inspect the equipment for shipping damage. If any damage is apparent, call your carrier claims agent and do not continue with the installation until the carrier has reviewed the damage.

NOTE: Read all instructions before starting the installation.

2. Lay out components to ensure you have all the required parts before proceeding (see Parts List on Page 2).

CAUTION: To prevent damage study all instructions and illustrations before you begin the installation. Failure to do so could render the Warranty for the Adapta-wall and the equipment that attaches to it null and void. Pay particular attention to the "Warnings" displayed in these Instructions.

STEP 1

1. Disconnect outer clamps **A** from clamp assemblies **B** and put to one side

(The mount **C** comes with nuts fitted in place of the 4 butterfly hand adjusters shown (S). You can use the nuts provided for fine adjustment by using a ratchet spanner or replace the nuts with the butterfly adjusters).

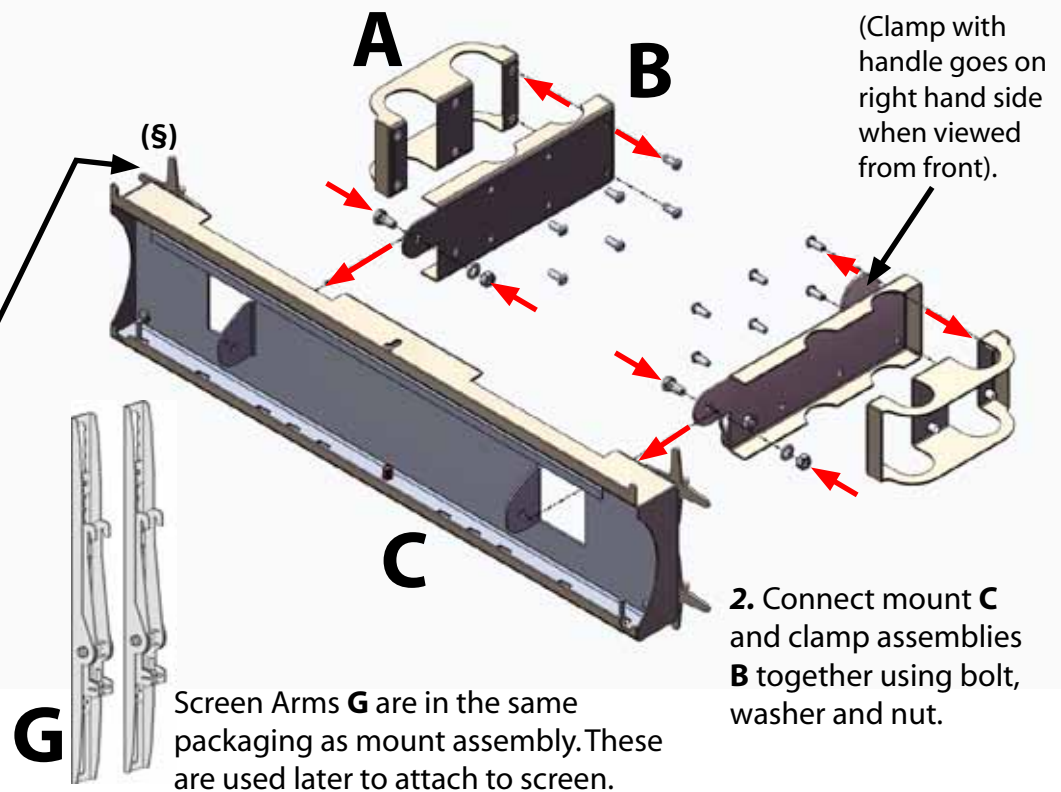

STEP 2

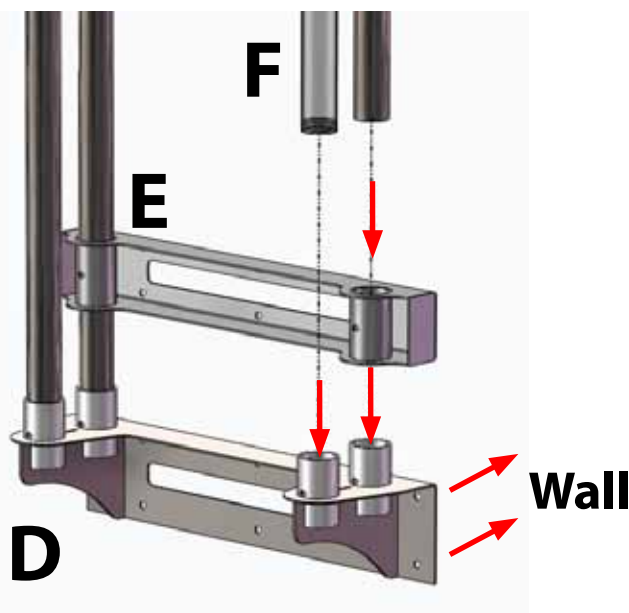

3. Fix bottom wall bracket **D** to wall using suitable anchors. See opposite page for fixing details.

Hold top wall bracket **E** in place over rear sockets of **D** and place columns **F** through the sockets of **E** and into sockets of **D**. Secure columns **F** by tightening grub screws in **D**.

4. Lift **E** to correct height for number of screens being used and fasten to wall making sure columns are level.

FIXING DETAILS (dimensions in mm)

WARNING: Improper installation can result in serious personal injury. Make sure that the structure you are fixing to can support a redundant weight factor five times the total weight of the equipment: if not, reinforce the structure before installing.

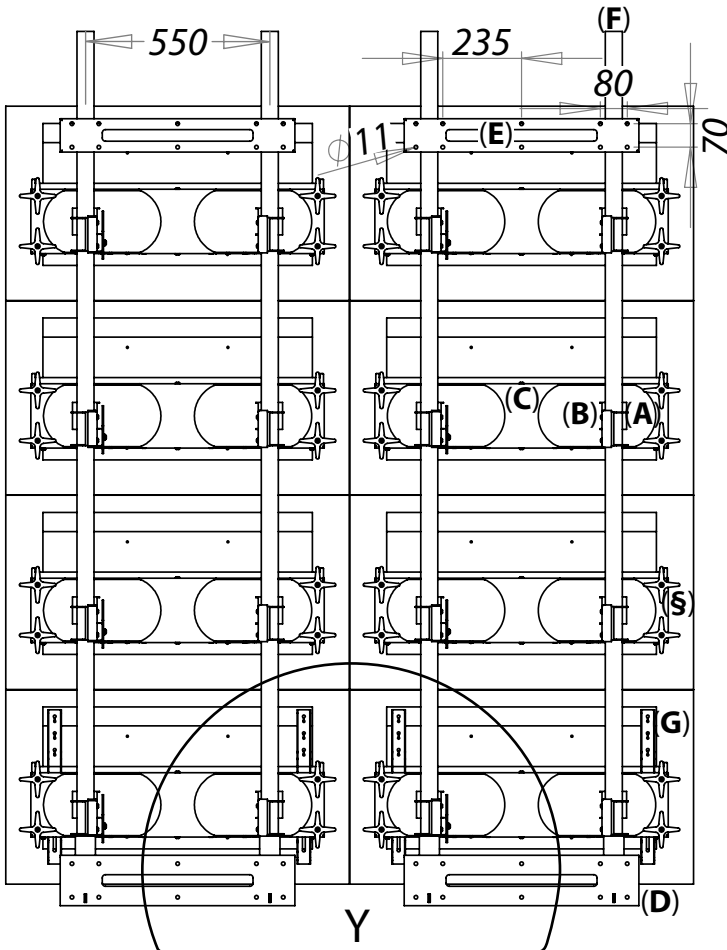

DETAIL Y
SCALE 1:10

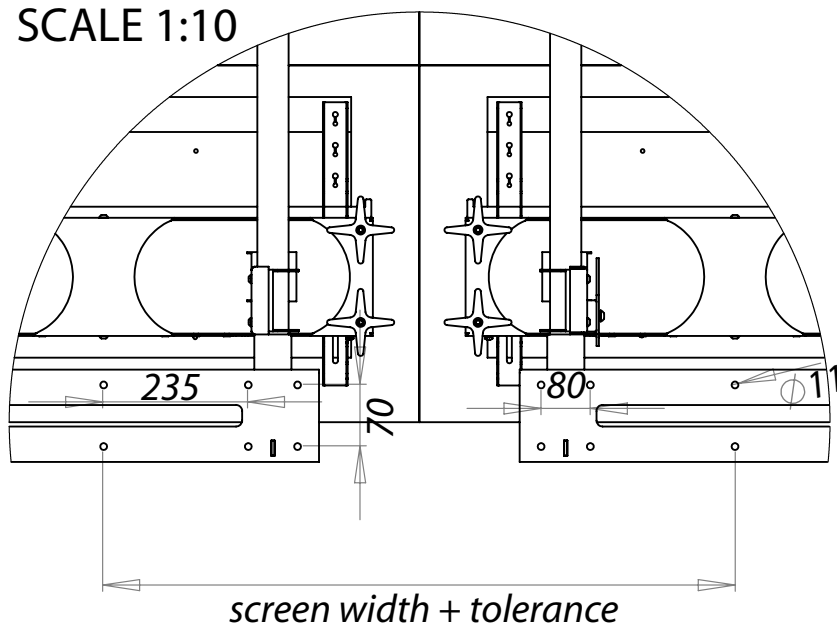

PARTS:

The amount of parts depends on the number of screens being installed (s).

Each stack of screens consists of:

- 1 x Bottom Wall Mount (D)
- 1 x Wall Mount (E)
- 4 x Columns (F)
- (s) x Mount Assemblies (in 3 parts):
 - 2 x Clamp Assemblies (A + B)
 - 1 x Mount (C)
 - 2 x Screen Arms (G)
- 4 x Butterfly adjusters (S) to replace adjusting nuts if required.

Note: We will provide the closest standard lengths of column for the amount of screens - these can be cut to length. If height is more than 3m we will provide double the amounts of columns with column joiners and additional Wall Mount. The joint must be supported by the Wall Mount midway.

CAUTION: We recommend installation by a Qualified Tradesperson, using masonry plugs or other reliable fixings to ensure safe installation. Consult your builder or architect if in doubt.

Cut columns to length on site.

Height of Wall Bracket (E) is determined by the number of screens. The wall bracket should be fitted above the top mount but below the top of screen. Intermediary wall mounts should be placed close to column joiners if supplied.

Wall fixing plates - centre to centre is one screen width plus any tolerance in drilling accuracy. There is fine width adjustment built into the screen mount for minor discrepancies.

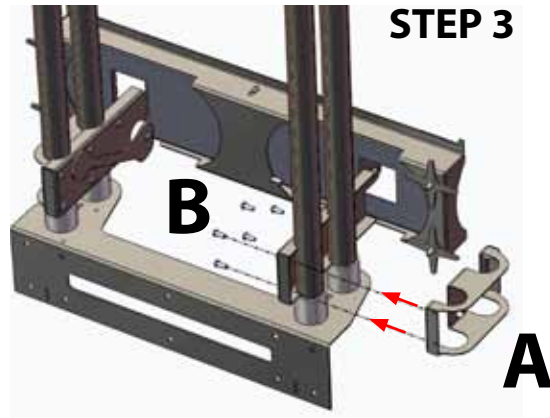

5. Fix mount to columns by connecting **A** to **B**. Rest bottom of mount clamp onto top of Wall Bracket socket.

6. Add the remainder of the mounts to the columns and temporarily fix at roughly a screen height apart.

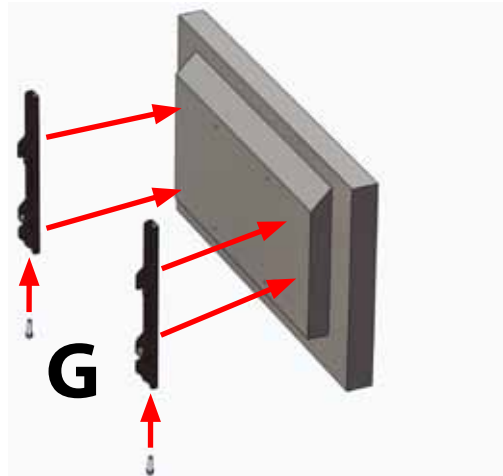

STEP 4

7. Fix mount arms **G** to screen.

8. Lift screens onto mounts starting from the bottom.

9. Secure Arms by tightening screws through corresponding hole in lower mount.

WARNING: Screens are heavy. We recommend at least 2 persons lift the Screen when fitting or if in doubt a hoist be used.

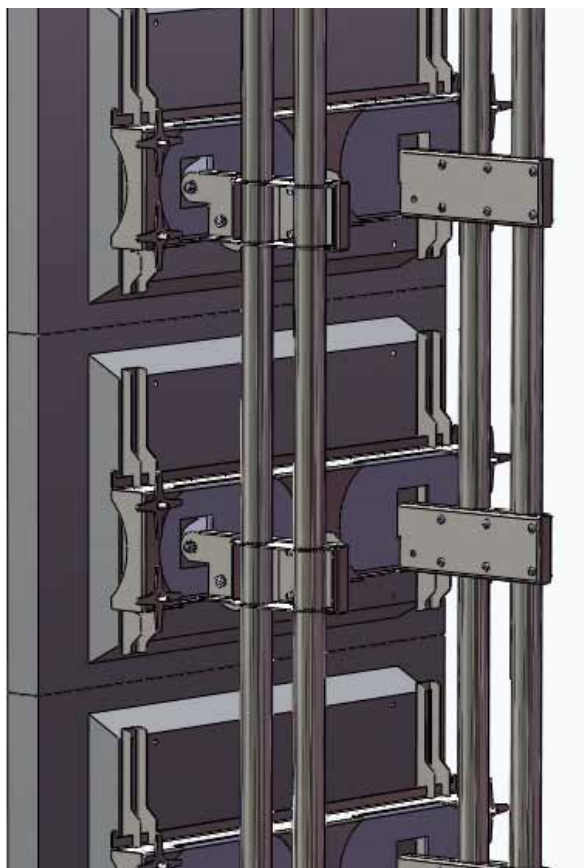

From Rear with screens butted together.



From Side with screens in tilt position.

STEP 5 - Adjusting screens

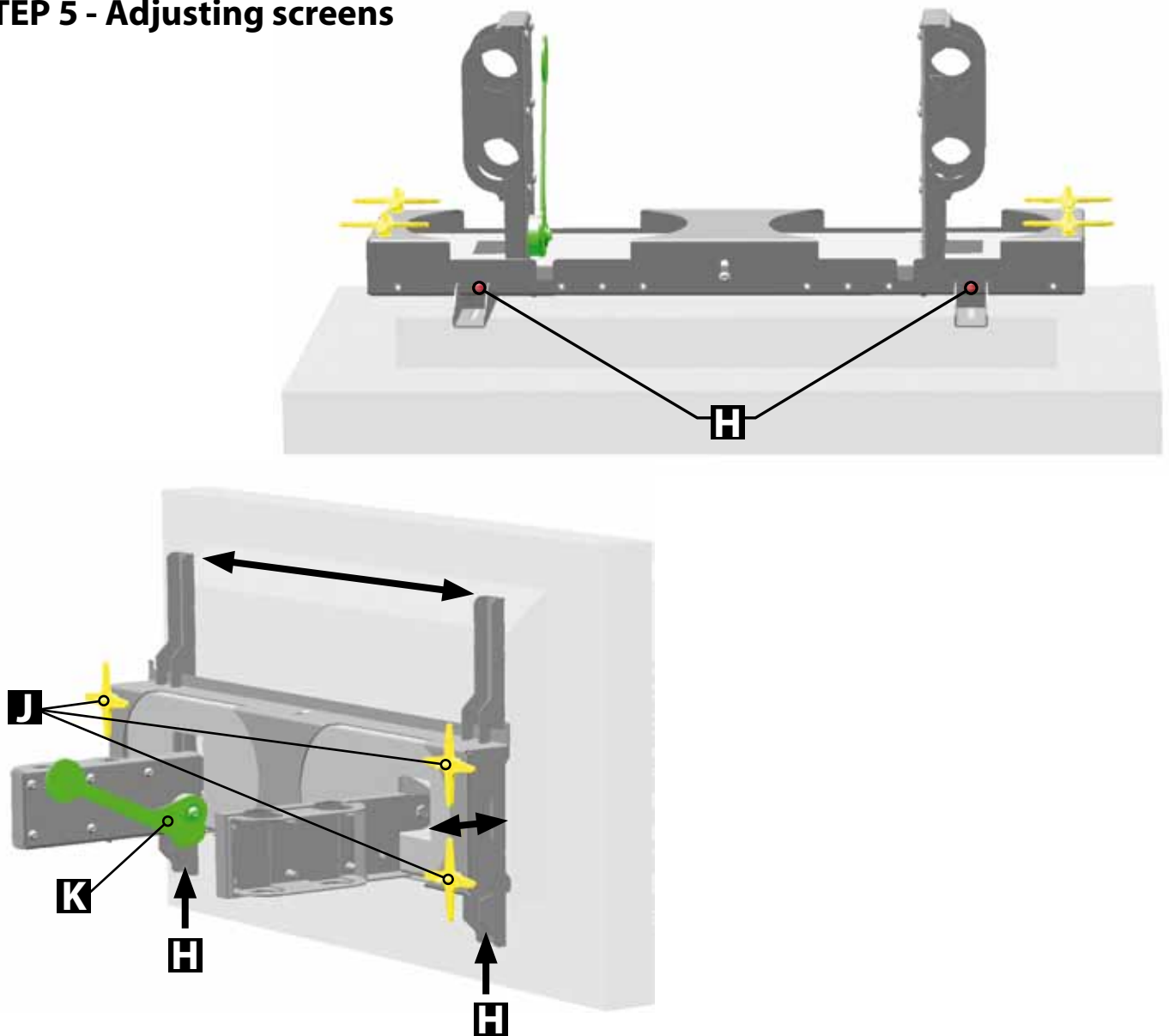

10. After allowing screens to butt together by loosening the mount clamps and re-tightening, fine adjustment can be carried out:

- * Start by ensuring top and bottom screens are roughly level in all planes with each other. All screens in between can then be adjusted.
- * Each screen can be tilted working from the top by pushing the top bezel of screen away from you. The handle **K** drops into place to lock screen in position. More tilt can be achieved by pulling handle towards you.
- * **Side to side levelling:** The screen can be moved from side to side by loosening screws **H** and manually lifting screen sideways to a new position.
- * **Screen Levelling:** The screen can be lifted at either side by tightening screws **H**.
- * **In - Out Adjustment:** The screen can be moved in and out by turning the butterfly adjusters **J** (or nuts if preferable).